

Masterplan design option 1

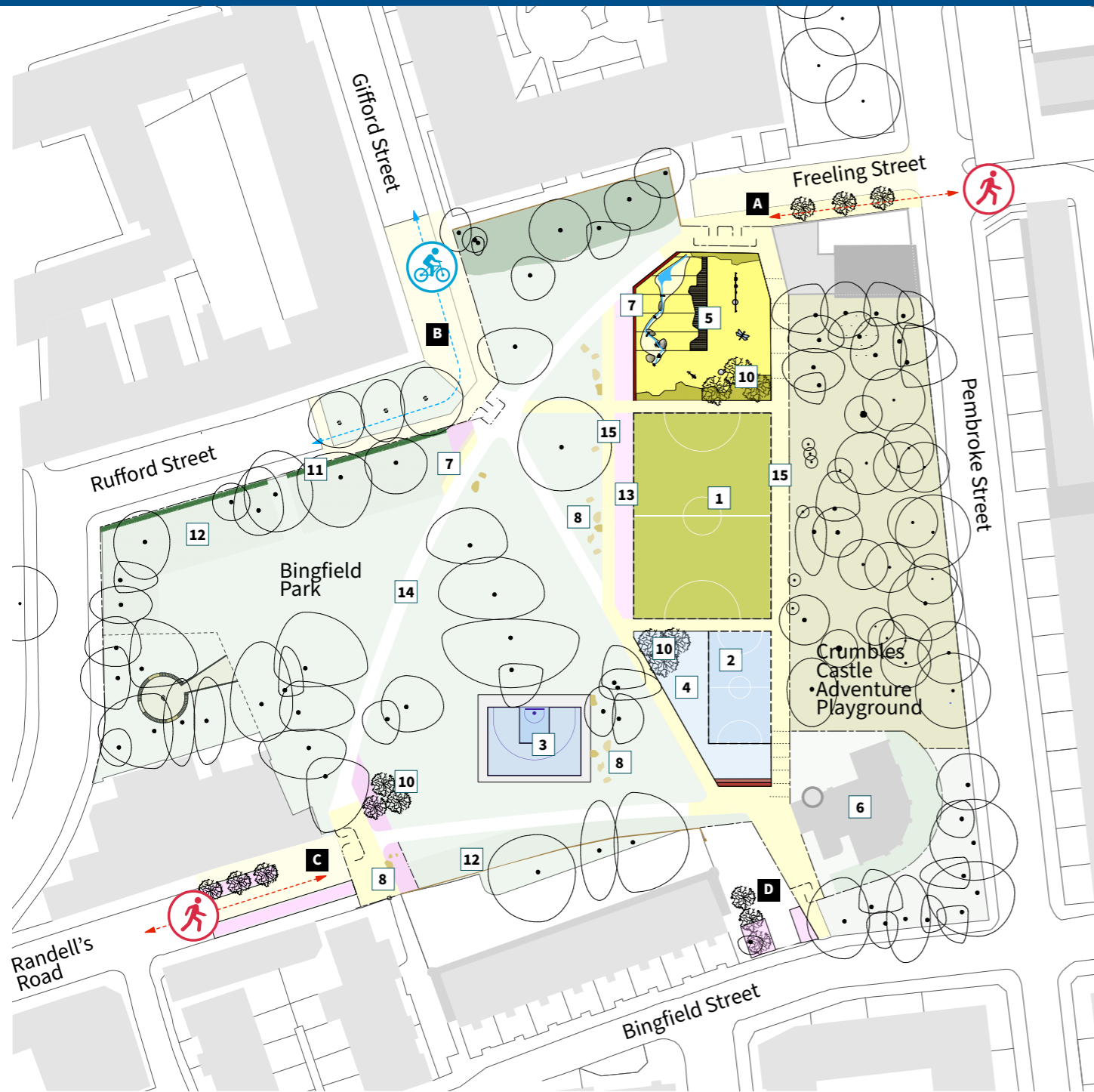

Approaches to the park

- A** Freeling Street
 - New paving
 - Street trees
 - New park entrance gates and chicanes
- B** Gifford Street and Rufford Street
 - Two way cycle lane
 - New paving
 - Rain gardens
 - New park entrance gates and chicanes
- C** Randell's Road
 - New paving
 - Rain gardens
 - Street trees
 - New park entrance gates and chicanes
- D** Bingfield Street
 - New paving
 - Rain gardens
 - Street trees
 - New park entrance gates and chicanes
 - Separate access for vehicles and pedestrians

Sport and play

- 1** Football pitch with artificial grass surfacing and floodlighting
- 2** Hard surface court for informal football and basketball
- 3** Basketball court (3 by 3)
- 4** Outdoor gym
- 5** Play area for under 7s

Crumbles Castle

- 6** Building retained (viable future use to be established)

Seating

- 7** New seating
- 8** Stone boulders

Trees and planting

- 10** New tree planting
- 11** Low wildlife hedge
- 12** Wildflowers
- 13** Rain gardens

Access

- 14** Existing footpath retained
- 15** New footpath

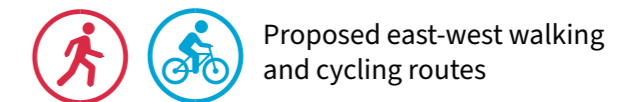

Below is a visual of Masterplan design option 1



This option is the same as option 2 but has the Crumbles Castle building left as it currently is. This option loses the skate area.