

Masterplan design option A

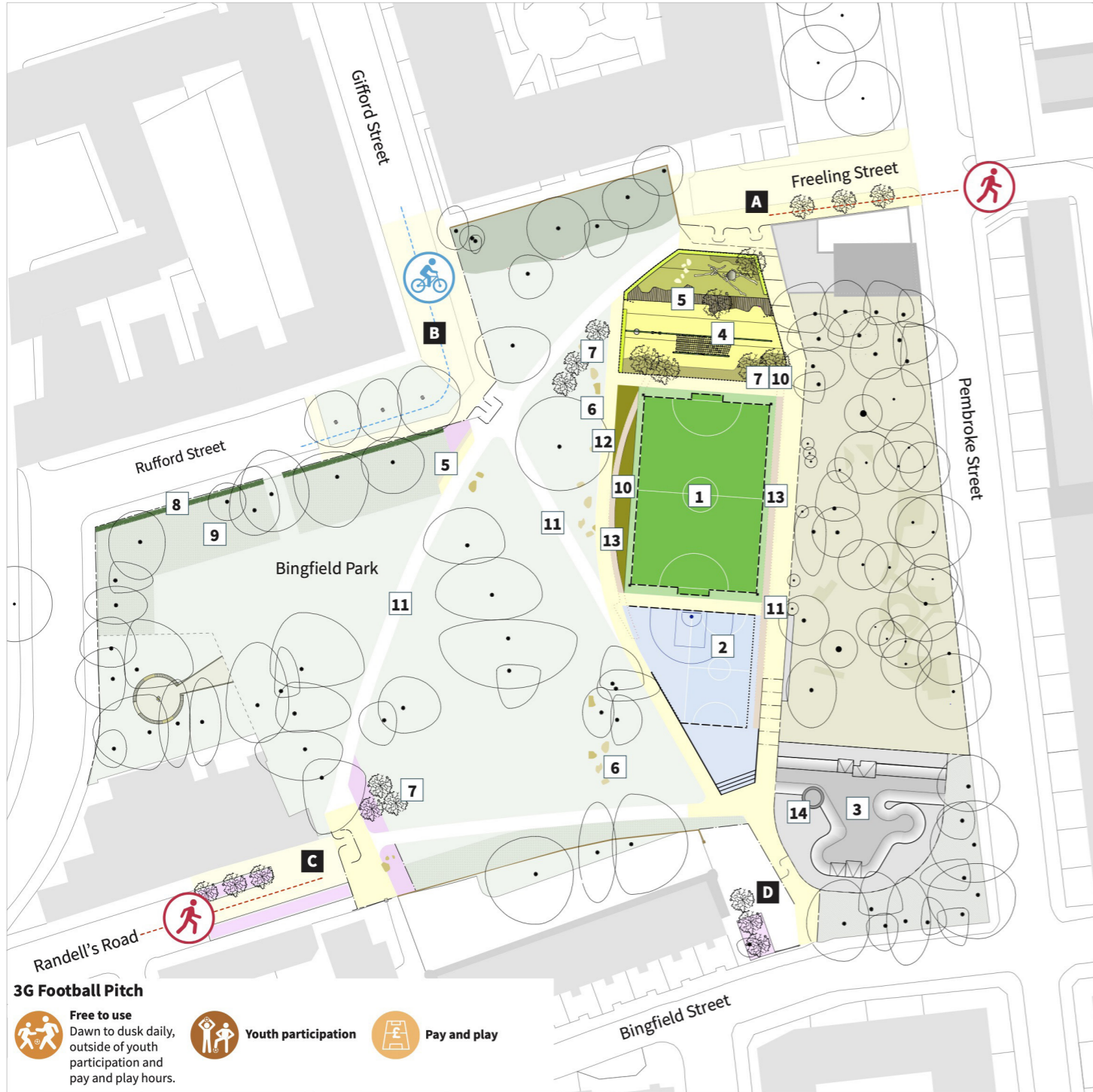

Proposed east-west walking and cycling routes

Plan A: 3G football pitch, half basketball court, children's playground and skate park with Crumbles Castle tower.

Approaches to the park

- A** Freeling Street
- New paving
 - Street trees
 - New park entrance gates and chicanes
- B** Gifford Street and Rufford Street
- Two way cycle lane
 - New paving
 - Rain gardens
 - New park entrance gates and chicanes

- C** Randell's Road
- New paving
 - Rain gardens
 - Street trees
 - New park entrance gates and chicanes

- D** Bingfield Street
- New paving
 - Rain gardens
 - Street trees
 - New park entrance gates and chicanes
 - Separate access for vehicles and pedestrians

Sport and play

- 1** Football pitch with artificial grass surfacing and floodlighting, rebound fencing height 3-4m to court boundary
- 2** Hard surface court for informal football and basketball, rebound fence height 3m to north, 1m to south and east)
- 3** Skate park / BMX street skate park
- 4** Play area for under 7s

Seating

- 5** New seating
- 6** Stone boulders

Trees and planting

- 7** New tree planting
- 8** Low wildlife hedge
- 9** Wildflowers
- 10** Rain garden

Access

- 11** Existing footpath retained
- 12** New footpath

Existing structures

- 13** Existing concrete walls and steps from existing ballcourt incorporated into proposed layout
- 14** Crumbles Castle landmark tower retained, materials from remaining building demolition re-used in the scheme



View of the proposed 3G football pitch from the footpath adjacent to Crumbles Castle Adventure Playground looking north.



View of the proposed 3G football pitch from the footpath adjacent to Gifford Street entrance looking south-east