

Proposed raised carriageway space in front of school, designed to calm traffic and improve pedestrian safety

Coloured circles proposed outside the school will increase drivers' awareness when driving through the space

Proposed planters with integrated seating

Proposed raised access to create a safer pedestrian environment

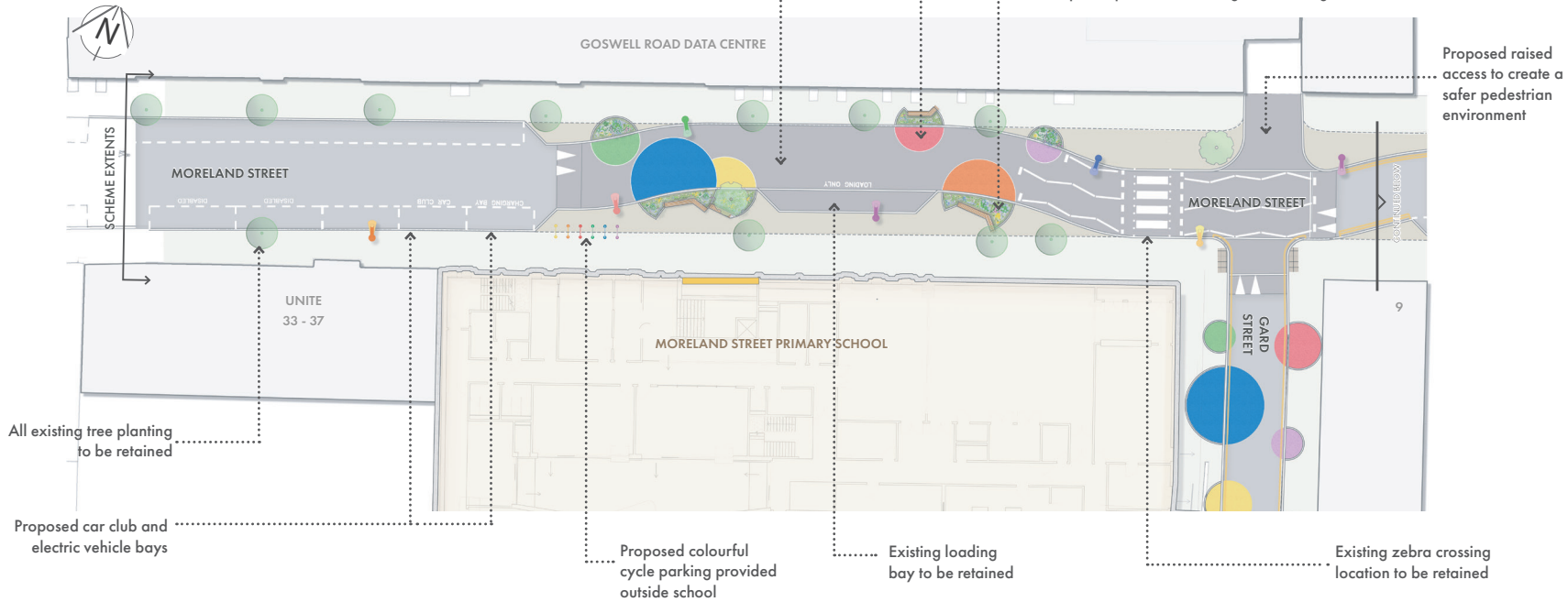

All existing tree planting to be retained

Proposed car club and electric vehicle bays

Proposed colourful cycle parking provided outside school

Existing loading bay to be retained

Existing zebra crossing location to be retained

Proposed raised side road to create a safer pedestrian environment

Existing zebra crossing location to be retained

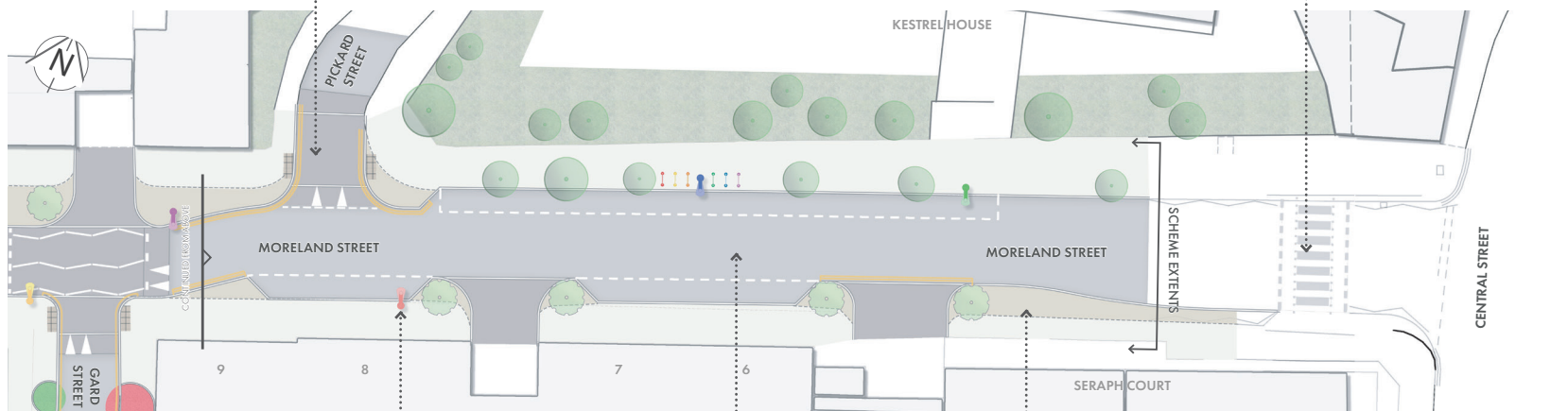

Proposed coloured lamp

Reduced carriageway

Proposed footway build outs provide extra width for



Artist's Impression of proposed planters with integrated seating