

# 4 Local Shopping Areas

- 4.1 Current Local Shopping Area (LSA) boundaries are designated in the DMP DPD, adopted in 2013.
- 4.2 The draft Local Plan – Strategic and Development Management Policies document, policy R4, identifies proposed LSA boundaries.
- 4.3 A number of changes are proposed to Islington’s LSAs, shown on the maps below. These changes involve the addition/removal of units, to reflect changes in the LSAs since the adoption of the DMP. Two existing LSAs – Archway Road and Westbourne Road – are proposed to be deleted due to the significance of the changes in the respective areas.
- 4.4 A number of other boundaries have been subject to minor changes to improve accuracy but do not add/remove units; these are not shown on the maps below, because of the minor nature of the changes.

# Archway Road Local Shopping Area Existing Boundary (designation removed)

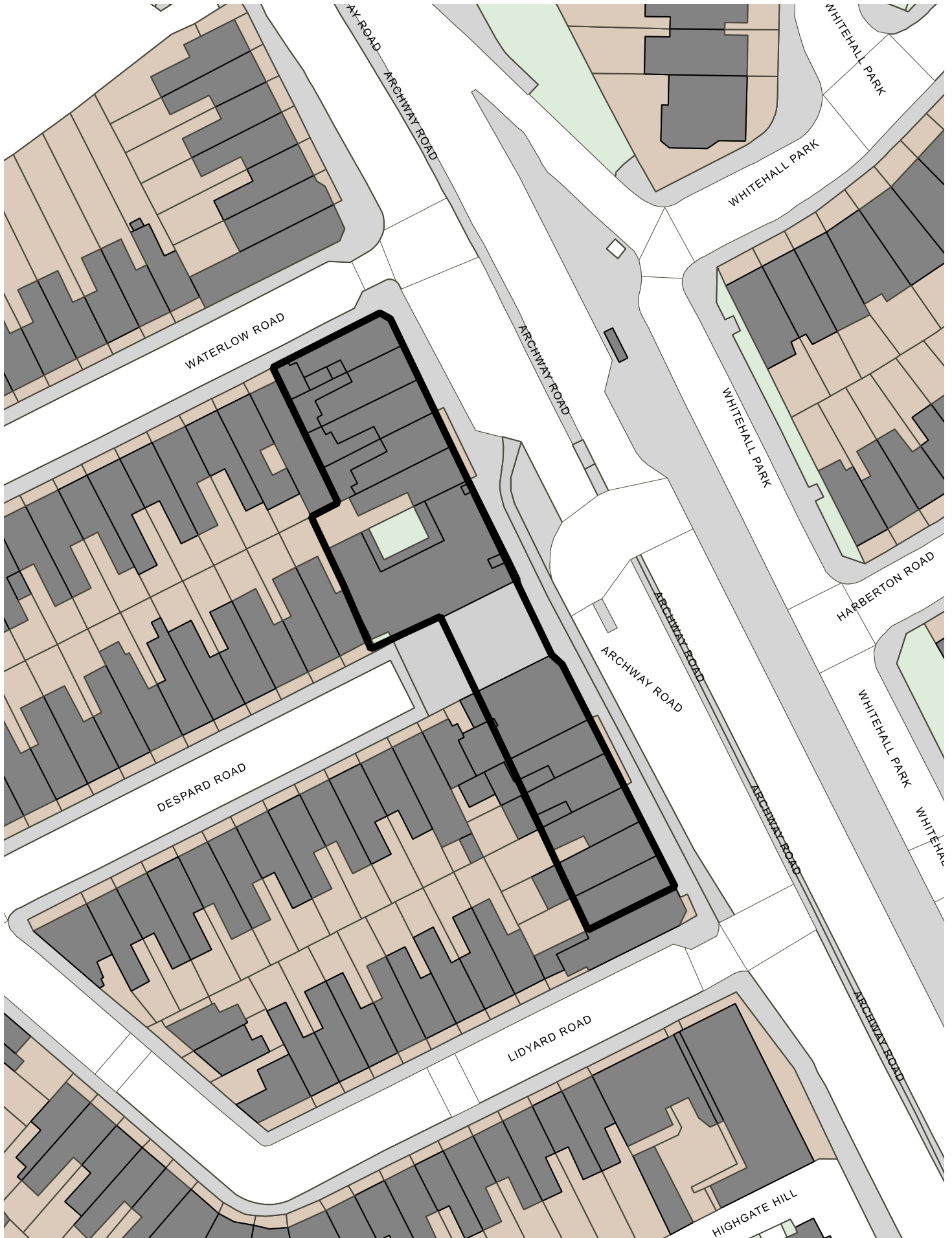

0 7 14 21 28 35 m



# Campdale Local Shopping Area Existing Boundary



0 4 8 12 16 20 m



# Campdale Local Shopping Area Proposed Boundary

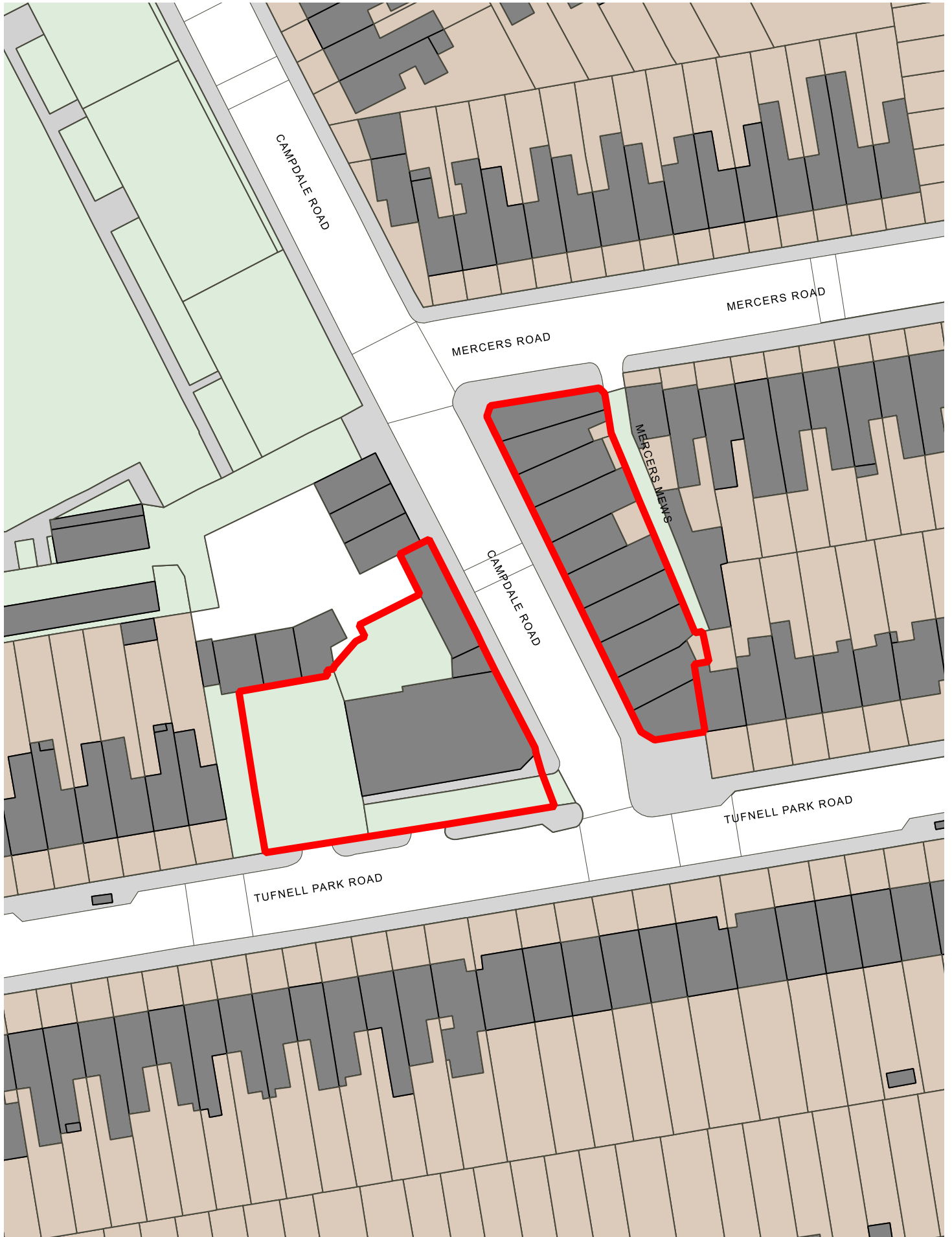

0 7 14 21 28 35 m



Contains OS data © Crown copyright and database right 2018

# Drayton Park Local Shopping Area Existing Boundary



0 4 8 12 16 20 m

# Drayton Park Local Shopping Area Proposed Boundary



0 3 6 9 12 15 m

Contains OS data © Crown copyright and database right 2018







# Farringdon Local Shopping Area Proposed Boundary (new designation)

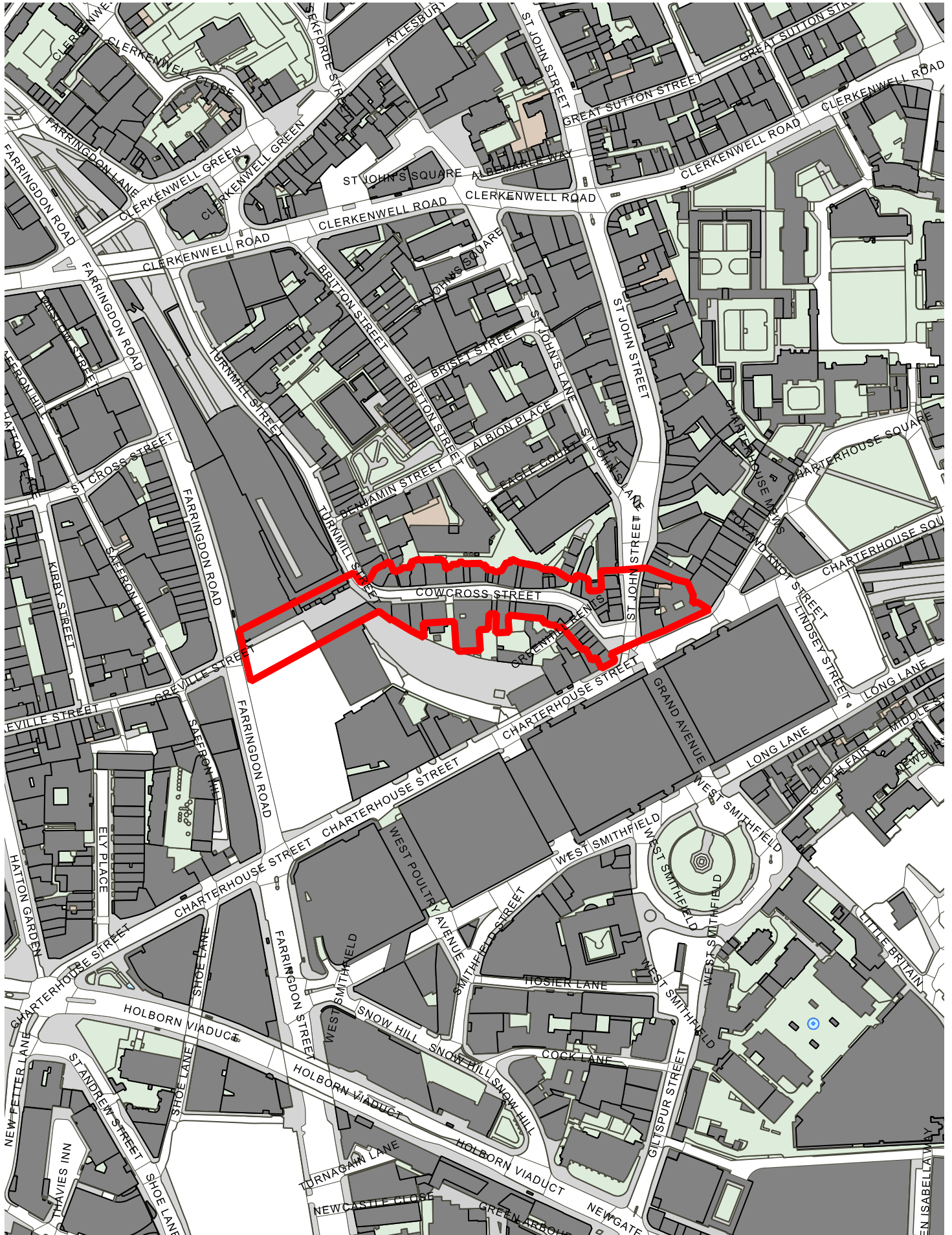

0 30 60 90 120 150 m



Contains OS data © Crown copyright and database right 2018

# Hornsey Road (Tollington) Local Shopping Area Existing Boundary

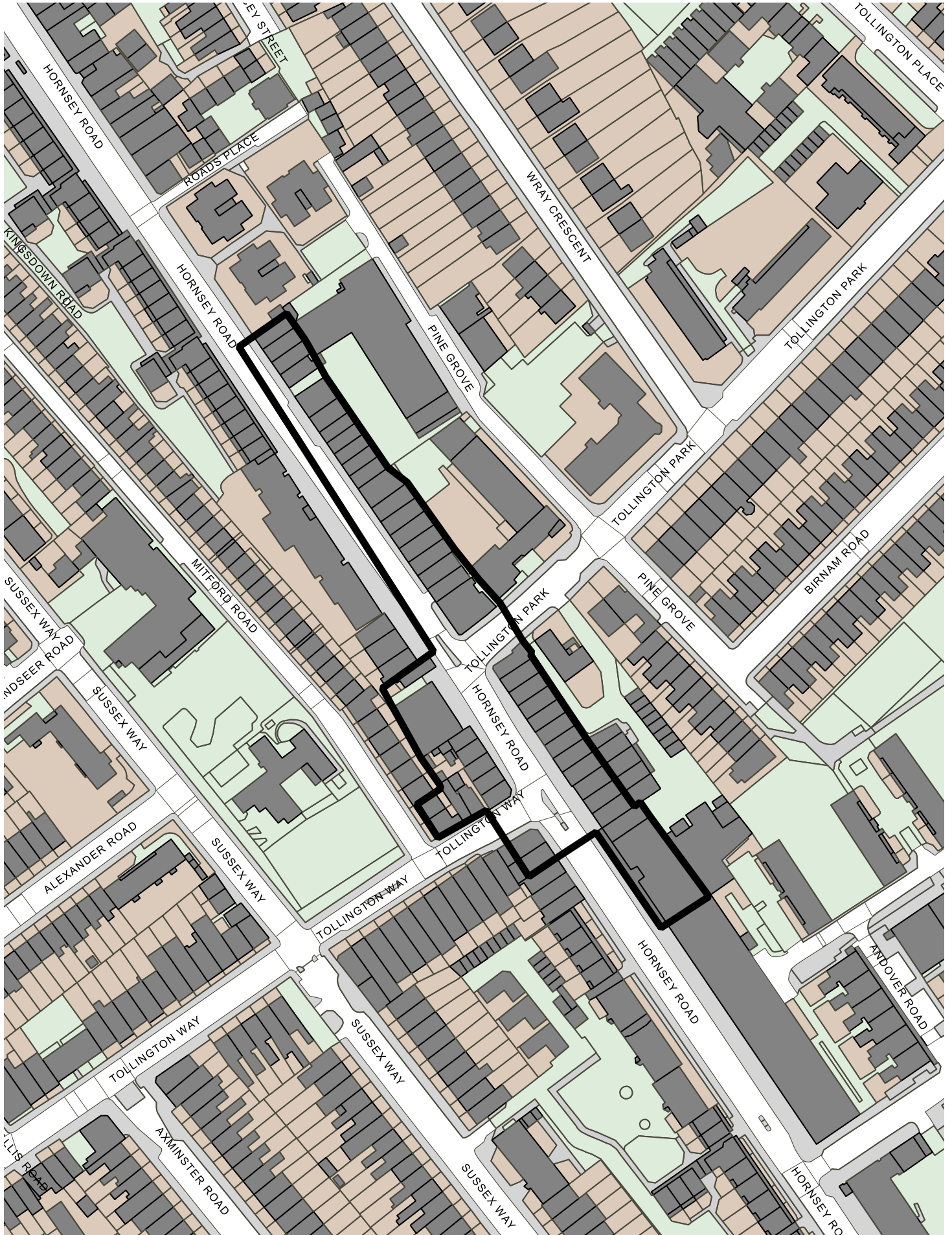

0 10 20 30 40 50 m



Contains OS data © Crown copyright and database right 2018

# Hornsey Road (Tollington) Local Shopping Area Proposed Boundary

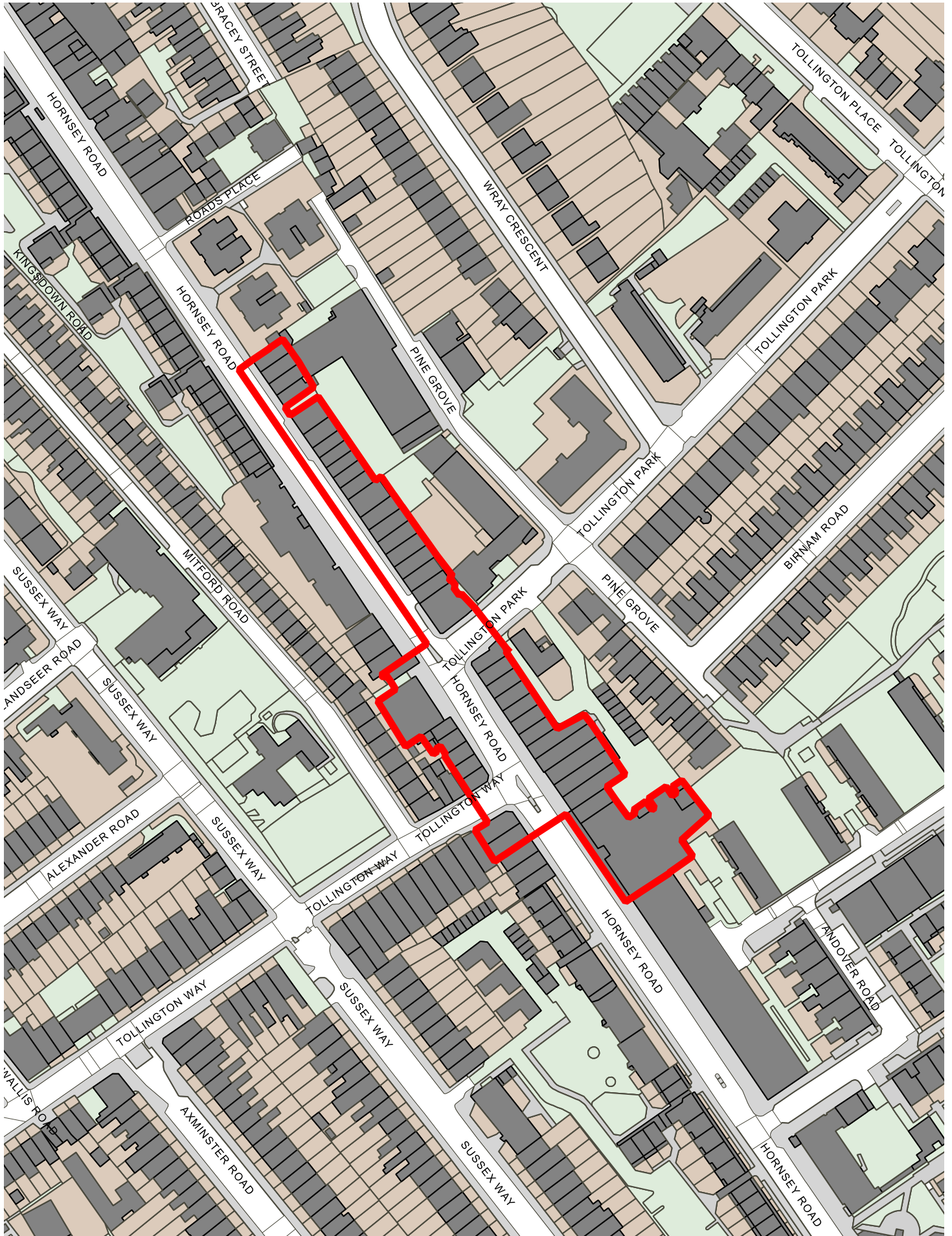

0 10 20 30 40 50 m



Contains OS data © Crown copyright and database right 2018

# Liverpool Road Barnsbury S Local Shopping Area Existing Boundary

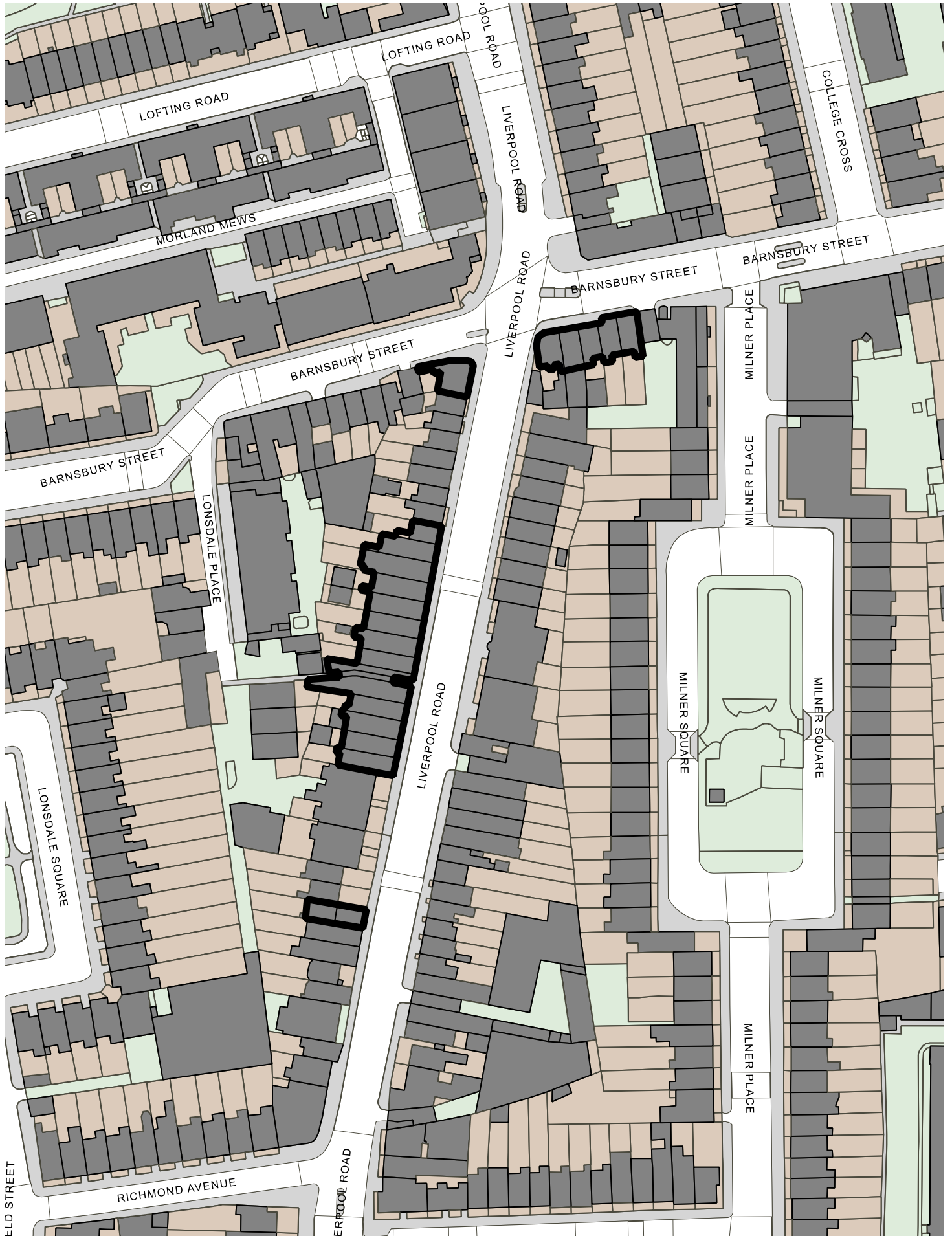

0 10 20 30 40 50 m

Contains OS data © Crown copyright and database right 2018

# Liverpool Road Barnsbury Street Local Shopping Area Proposed Boundary

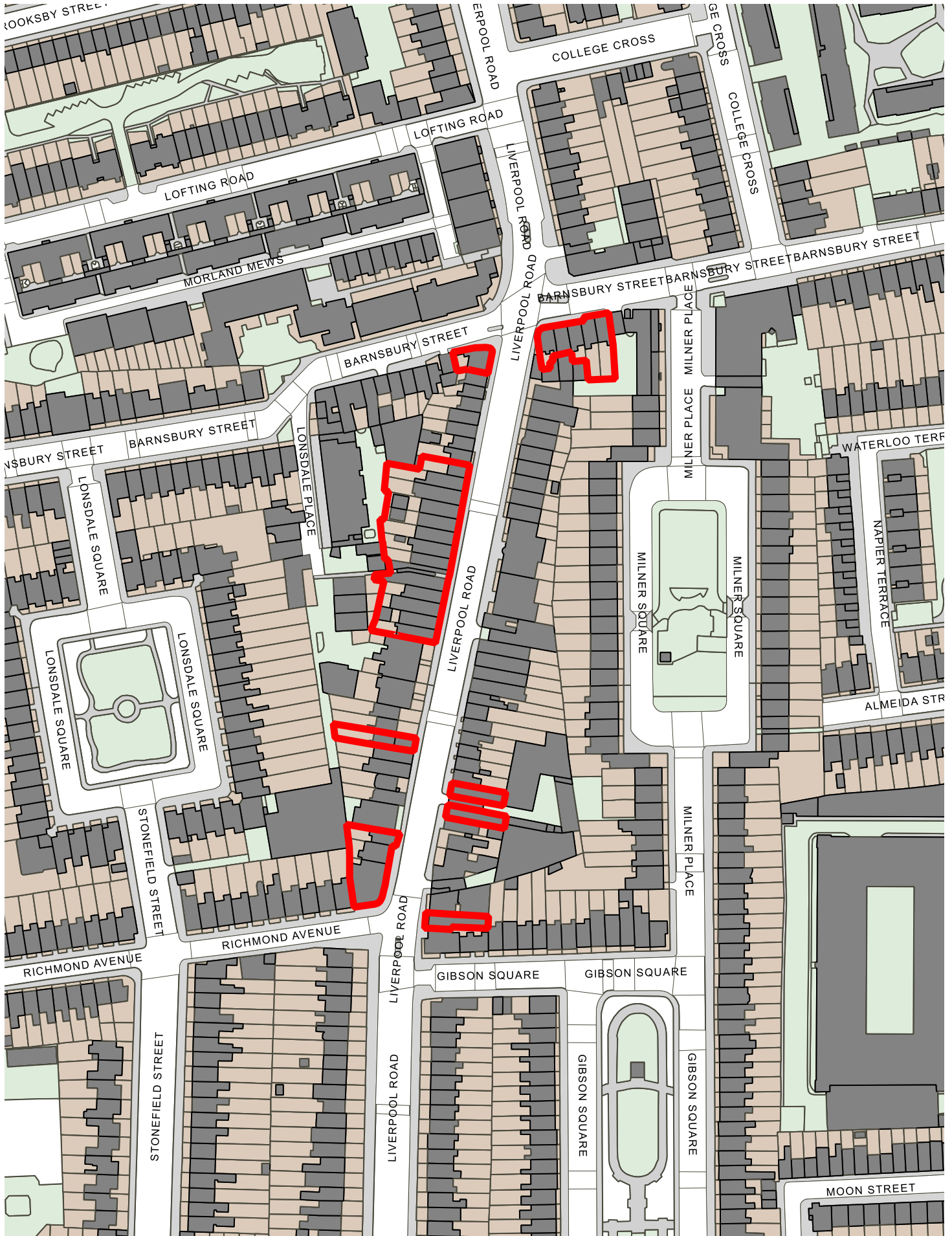

0 10 20 30 40 50 m



Contains OS data © Crown copyright and database right 2018

# Lower Holloway Local Shopping Area Existing Boundary

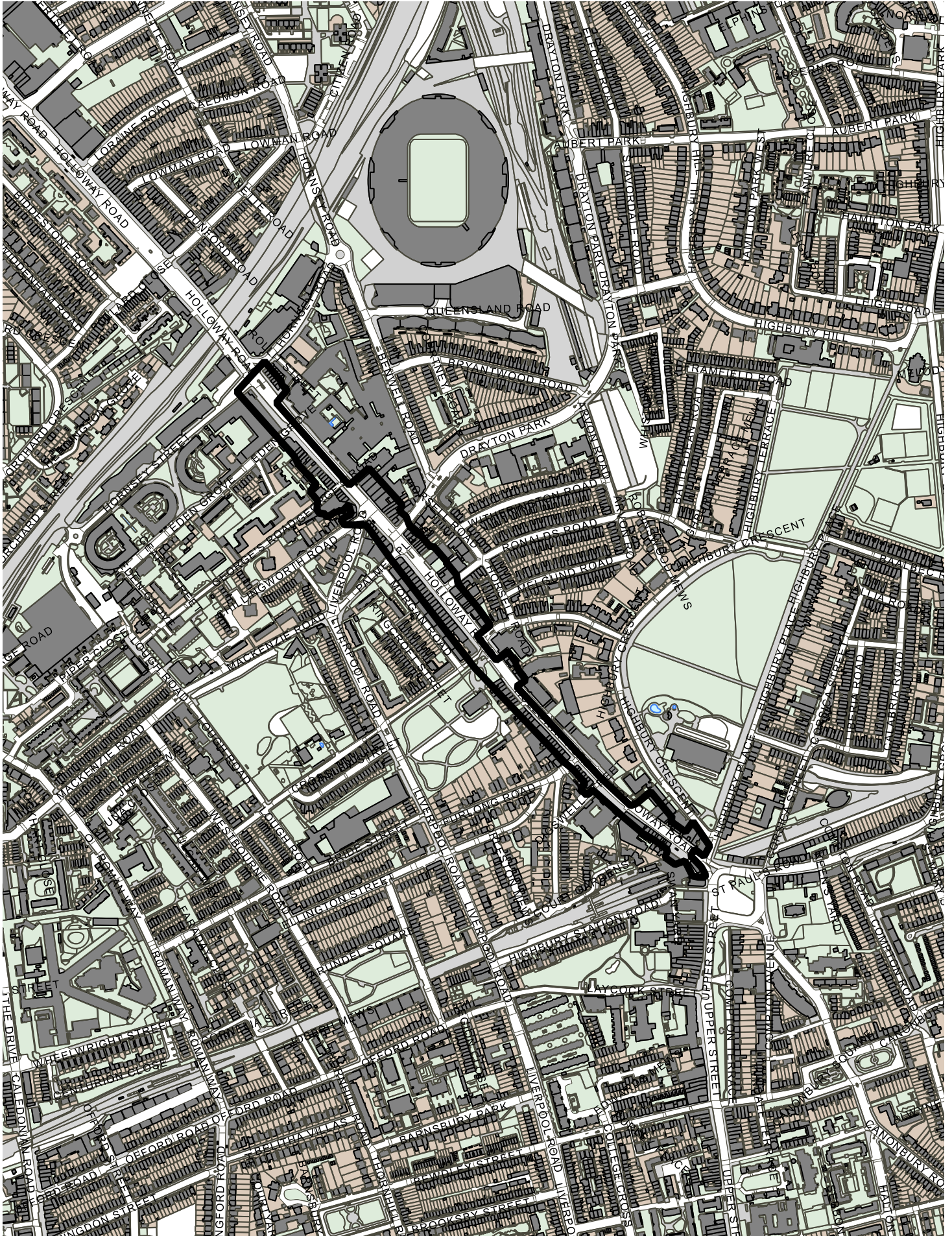

0 60 120 180 240 300 m



Contains OS data © Crown copyright and database right 2018

# Lower Holloway Local Shopping Area Proposed Boundary

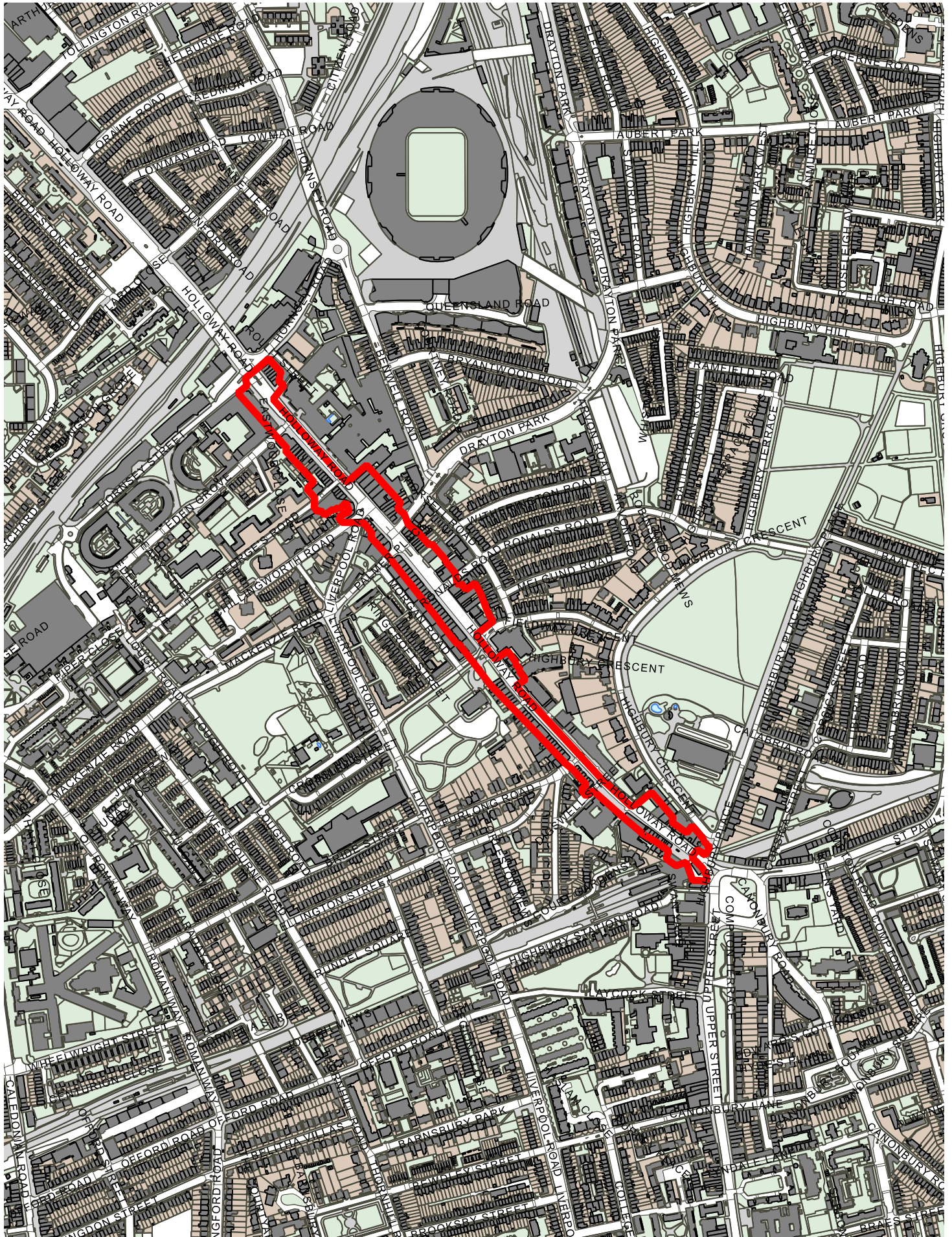

0 60 120 180 240 300 m



Contains OS data © Crown copyright and database right 2018