

Next steps

Dates are estimated at this stage.



Deadline for residents feedback and questionnaire return	21 July 2022
Update newsletter	Summer 2022
Second consultation event	September 2022
Planning application submitted	Autumn 2022
Construction start on site	Autumn / winter 2023

Consultation event

We would like to hear what you think of our proposals to build much-needed new homes at Elmore Street and Lindsay Mews.

Please come along to our residents drop-in event on **Thursday 23 June 2022**, between **3.30pm and 7.30pm**. You can chat to the architects and Islington Council's new build team about the proposals and submit your feedback via the enclosed feedback form or online at www.islington.gov.uk/consultations by **21 July 2022**.

Priority for local people

Local residents get priority for the new council homes. Under Islington Council's local lettings policy existing estate tenants and family members who meet the local lettings criteria qualify.

Priority is given to those looking to downsize, living in overcrowded properties, or who have needs that are not being met in their current homes. For more information, visit our website:

www.islington.gov.uk/housing



Entrance view

This newsletter is available online at www.islington.gov.uk/newbuild

If you would like this information in another language or reading format, such as Braille, large print, audio or Easy Read, please contact 020 7527 2000.

Published June 2022

How to get in touch

If you have any questions, please contact:

Patrick Neville,
New Homes Development Project Manger
Islington Council

 020 7527 6058

 patrick.neville@islington.gov.uk

Elmore Street and Lindsey Mews – new build proposals

June 2022

Islington Council is committed to tackling the current housing crisis, including building 750 new council homes across Islington.

We are in the early stages of looking at building new homes and making estate improvements to the Elmore Street and Lindsey Mews area. This newsletter gives you an introduction to our initial design proposals.

We are developing our proposals to build approximately 13 new homes and to improve the estate landscaping and resident amenities at Lindsey Mews and Elmore Street.

We have developed some initial design ideas to build much needed new homes here. We would like to share these ideas with you and gather residents valuable feedback.

We have carried out initial site instigations and surveys to help us understand what we can build. We have identified the opportunity to build 12-13 new homes.

We would like your input about these initial designs and information on what



improvements you would like to see where in this area.

Your input will inform the design proposal and help us to enhance estate facilities, improve the landscaping and built environment where you live. Please come along to our **drop-in event on 23 June** and have your say.

Turkish/Türkçe

Bu haber bülteni inşa etmeyi planladığımız aşırı ihtiyacı duyulan yeni evler ve yerel alanınızda yapmak istediğimiz iyileştirmeleri haber vermektedir. Bu haber bültenini başka bir dilde isterseniz bize lütfen bildirin.

Somali/Soomaali

Wargeyskani wuxuu kuu sheegayaa guryaha cusub ee aadka loogu baahan yahay ee aan qorsheyneyno inaan dhiso iyo hagaajinta aan dooneyno inaan ku sameyno degaankaaga. Haddii aad jeclaan lahayd warsidahan oo af kale ku qoran fadlan nala soo socodsii.

Bengali/ বাংলা

আমরা আপনার এস্টেট তথা বসত এলাকায় যসেব নতুন ঘরবাড়ি নির্মাণ করার পরিকল্পনা করছি এই নিউজপেপার আপনাকে সে সম্পর্কে তথ্য প্রদান করে এবং সলাপরামর্শমূলক অনুষ্ঠানগুলো হতে পরাপ্ত মতামত এবং পরবর্তীতে কি ঘটবে সে সম্পর্কিত তথ্যবলী এটিতে অন্তর্ভুক্ত রয়েছে। আপনি যদি বাংলায় এই নিউজপেপারটি পতে চান, তাহলে অনুগ্রহ করে ইমইল বা ফোনের মাধ্যমে আমাদের সাথে যোগাযোগ করুন।

Initial ideas – what would you like to see in this space?

The drawing shows the locations of the new homes and the proposed landscaping improvements at Lindsey Mews.

Initial ideas to explore:

1. Raised planters with seating
2. Interactive space for children made from natural materials
3. Areas of hard and soft landscaping
4. Bug hotel and bird boxes
5. Tree planting and increased biodiversity

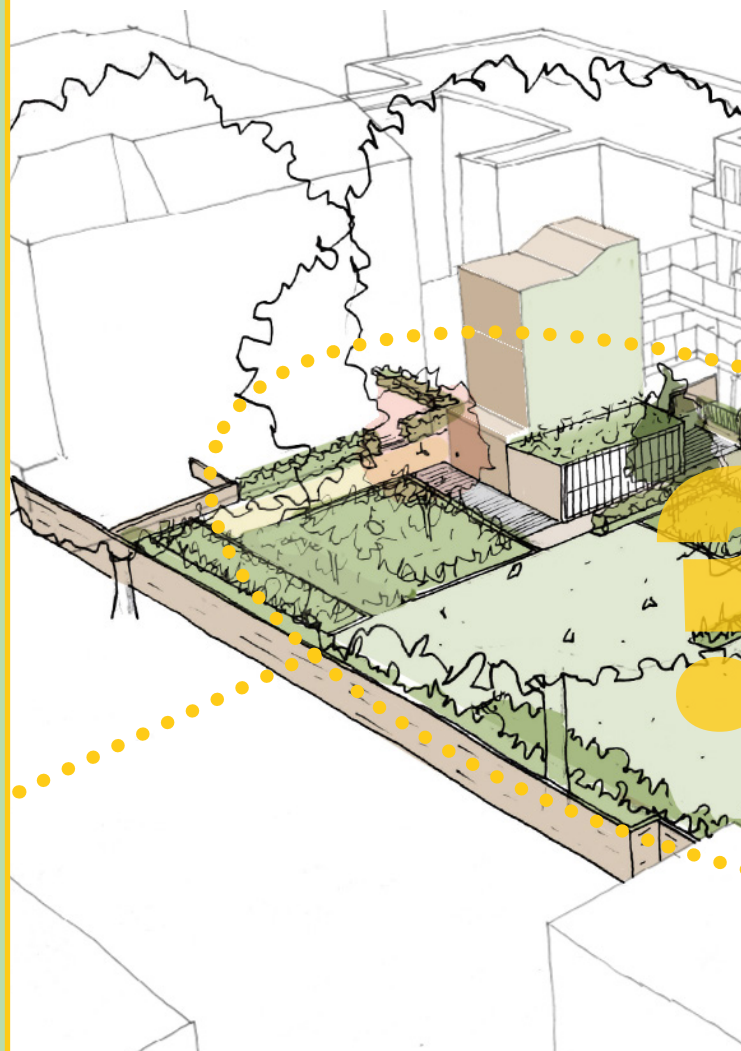

Street views of the proposed new homes

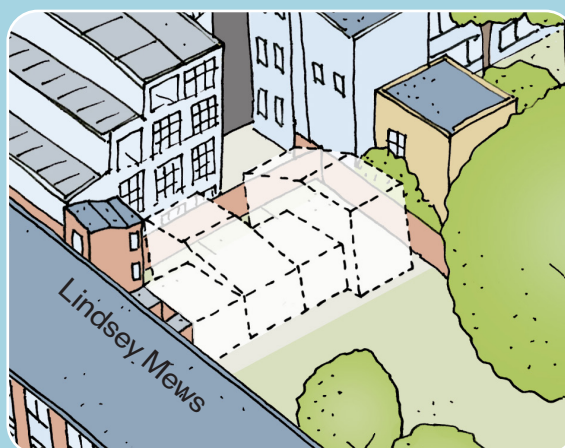

Building A – two proposed mews homes

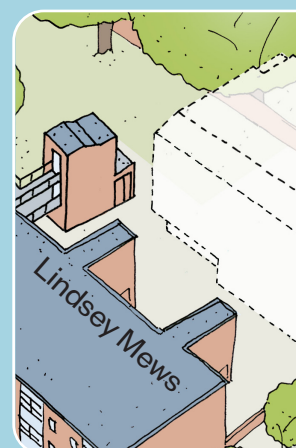

Building B – eight proposed mews homes on Elmore Street

Your feedback is important to us. Please consider these design ideas and let us know what you think and what improvements you would like to see.

We welcome your feedback on these suggestions at our drop-in event and via the feedback form.

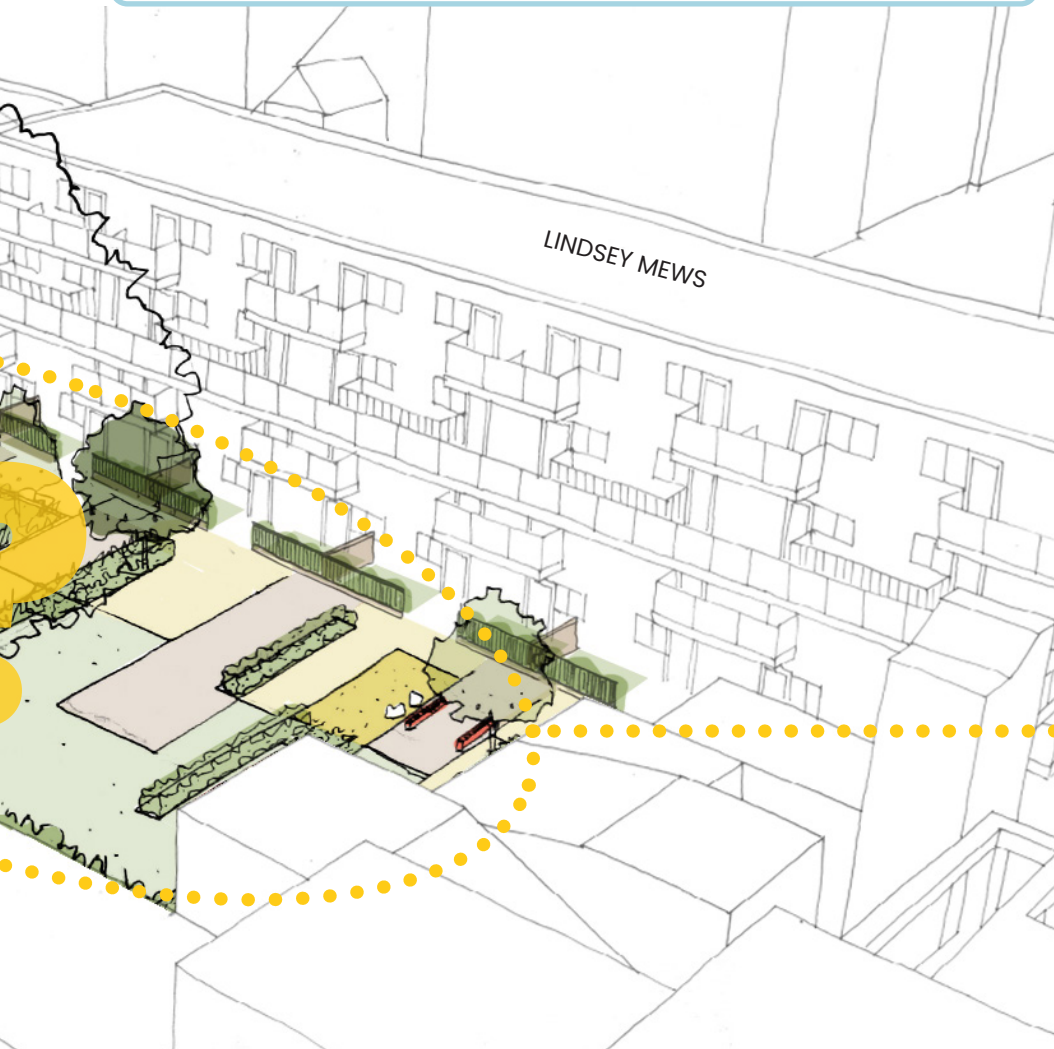

Ideas for improved estate amenities

- A. Better accessibility across the estate
- B. Improved bin and recycling provision
- C. Cycle parking
- D. Better lighting and signage

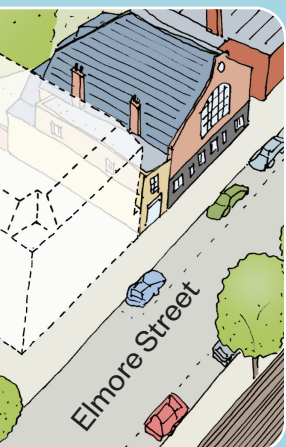

Proposed new street



Building C - three proposed new homes